



User’s manual
VM344/VM344-2

Safe & Sound®
Pan & Tilt Full Color
Video Monitor



Congratulations

on purchasing your new VTech product.
Before using this product, please read
Important safety instructions.

For support, shopping, and everything new at
VTech, visit our website at
www.vtechphones.com.

Register online to get an additional
3-month warranty!

Visit www.vtechphones.com.



Registration

Register your product online for
enhanced warranty support.



Product news

Learn about the latest VTech
products.

What’s in the box

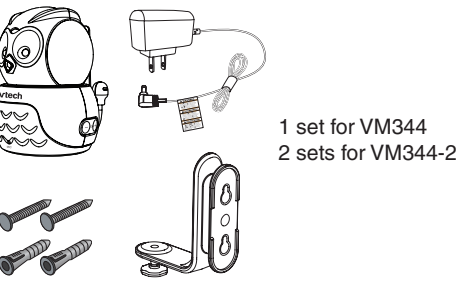
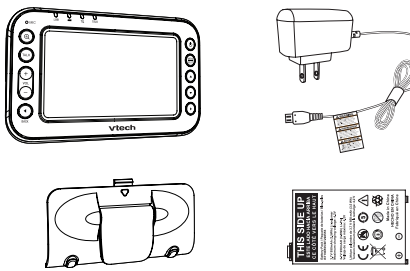

1 set for VM344
2 sets for VM344-2

Install the battery

You can power up the parent unit by
connecting it to AC power or to the
rechargeable battery provided. Even if the
parent unit is connected to AC power, we
recommend you also install the battery. This
guarantees continual operation in case of a
power outage.

Install the battery as shown below.

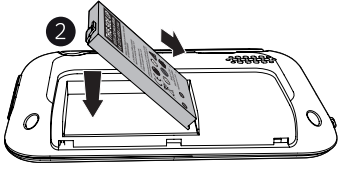
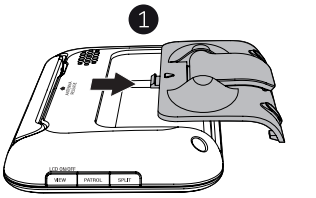

NOTE

- Make sure the label **THIS SIDE UP** is facing up
while inserting the battery.

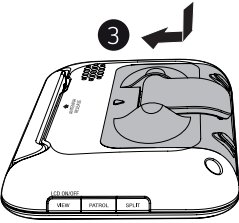

NOTES

- The operating time for using the rechargeable
battery is short. If you want to monitor your baby
for a long time, we recommend you connect the
parent unit to AC power.
- If the parent unit will not be used for a long time,
disconnect and remove the battery to prevent
possible leakage.

Connect and charge the
battery

NOTES

- Use only the battery supplied with this product.
- Use only the power adapters supplied with this
product.
- Make sure the electrical outlets are not controlled by
wall switches.
- The power adapters are intended to be correctly
oriented in a vertical or floor mount position. The
prongs are not designed to hold the plug in place
if they are plugged into a ceiling, under-the-table
or cabinet outlet.
- Make sure the parent unit, the baby unit and the
power adapter cords are out of reach of children.

Connect the baby monitor

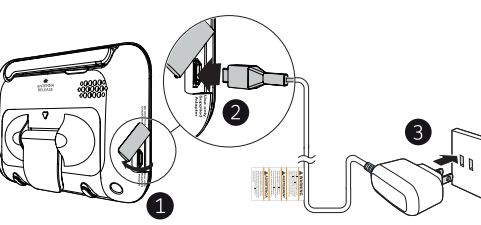
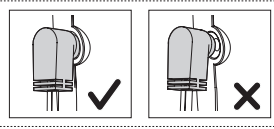
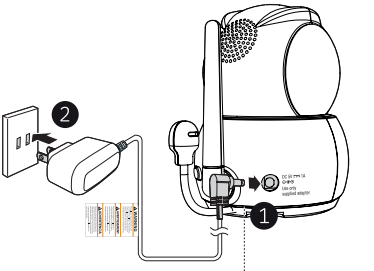

Charge the parent unit battery

When you have connected the parent unit
and installed its battery for the first time or
after power outage, the parent unit powers on
automatically. The battery icon indicates the
battery status (see the following table).

NOTES

- The parent unit battery is fully charged after
3 hours of continuous charging.
- It takes longer to charge the battery when the
parent unit is turned on. To shorten the charging
time, turn the parent unit off while charging.
- The standby time varies depending on the
sensitivity level you set, your actual use and the
age of the battery.

Battery indicators	Battery status	Action
The battery icon is off and displays.	No battery is installed but operates using AC power, or the battery has been installed incorrectly.	Install the parent unit battery. Charge without interruption (at least 30 minutes).
The screen displays Battery low at Parent Unit and the light flashes.	The battery has very little charge and may be used for only a short time.	Charge without interruption (about 30 minutes).
The battery icon becomes solid.	The battery is fully charged.	To keep the battery charged, connect it to AC power when not in use.

Before use

You may test the baby monitor before initial
use, and at regular times thereafter.

To test your baby monitor:

- Place the parent unit and the baby unit in
the same room to test the product. Make
sure the baby unit is at least 1 meter / 3
feet away from the parent unit.
- Slide **ON/OFF** on the baby unit to turn it on.

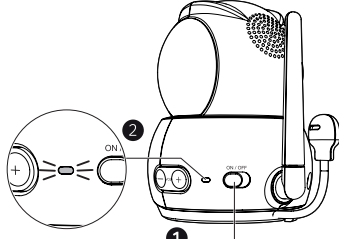

- Connect the parent unit to AC power.
Upon initial use, the parent unit powers on
automatically. The screen shows **vtech®**
and **Powering on...**

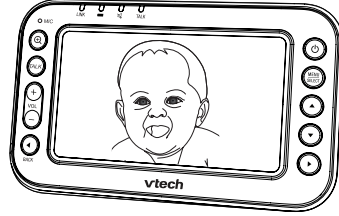

NOTE

- If both units are not connected, the parent
unit displays **No link to CAM #**
(# represents the selected baby unit number) on
the screen. The **LINK** LED light first flashes and
then turns off. Move the parent unit closer to the
baby unit.

Positioning the baby monitor

NOTE

- This baby monitor is intended as an aid. It is not a
substitute for proper adult supervision, and should
not be used as such.

CAUTION

- Keep the baby unit out of the reach of your baby.
Never place or mount the baby unit inside the
baby’s crib or playpen.

- Place the baby unit at least 1 meter / 3 feet
away from your baby. Adjust the angle of
the camera to aim at your baby.

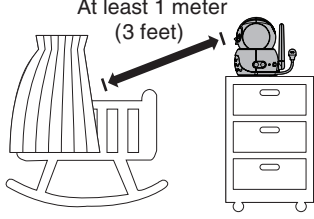

- Place parent unit at least 1 meter / 3 feet
away from the baby unit.

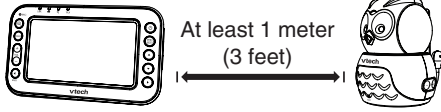

NOTE

- If you experience audio feedback on either
the parent unit or baby unit, move the parent
unit further away until there is no more audio
feedback.

TIP

- If you cannot hear the sounds transmitted from
the baby unit, you can choose a higher sound
sensitivity level and increase the speaker volume
of the parent unit.

Operating range

The operating range of the baby monitor is
up to 300 meters (1,000 feet) outdoors or
50 meters (160 feet) indoors. The actual
operating range may vary depending on
the environmental conditions and other
interferences such as walls, doors and other
obstructions.

Overview

Baby unit overview

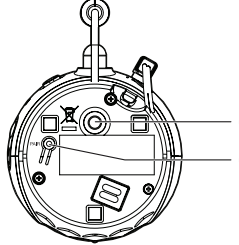
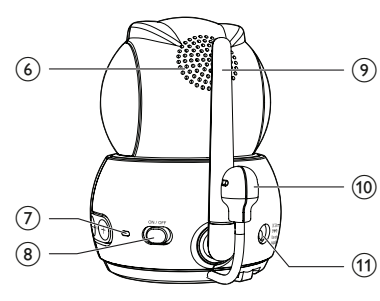
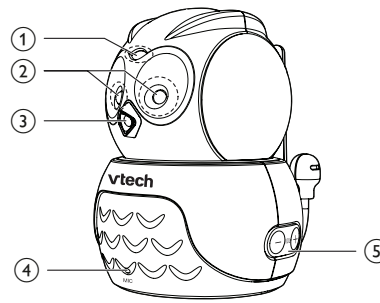

1	Light sensor
2	Infrared LEDs
3	Camera
4	Microphone
5	-/VOL/+ • Press to adjust the listening volume.
6	Speaker
7	ON/OFF LED light • On when the baby unit is turned on and is paired to the parent unit. • Flashes when the baby unit is pairing to the parent unit.

Parent unit overview

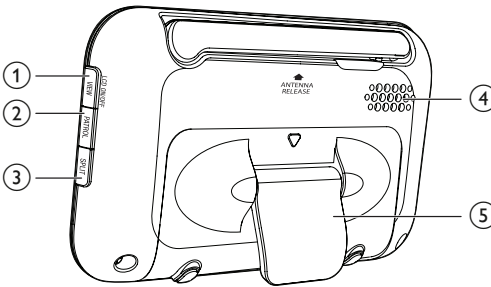

1	LCD ON/OFF • Press and hold to turn off the parent unit screen. VIEW • Press to view the image of the next baby unit in SINGLE-CAM or PATROL mode.
2	PATROL • Press to turn on or off the PATROL mode.
3	SPLIT • Press to turn on or off the SPLIT-VIEW mode.
4	Speaker
5	Stand

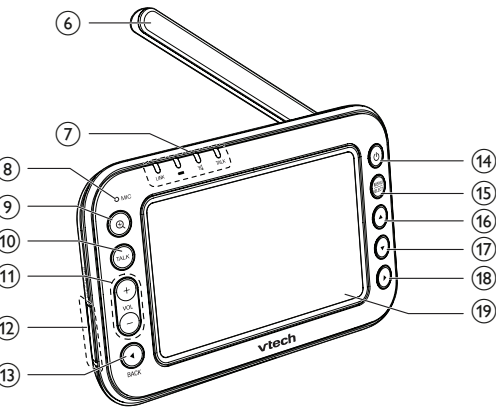

6	Antenna
7	LED lights • Indicate the different statuses of the parent unit. For details, refer to Parent unit lights .
8	Microphone
9	Zoom • While viewing image, press to zoom in or out.
10	TALK • While viewing image, press and hold to talk to the selected baby unit.
11	+VOL/- • Press to adjust the speaker volume.
12	Power jack
13	BACK • While in a menu, press to return to the main menu or idle screen. • While viewing image, press and hold to move the image leftward.
14	On/off • Press and hold to power on. • Press and hold again to power off.
15	MENU/SELECT • Press to enter the menu. • While in a menu, press to choose an item, or save a setting.

16	▲ • While in a menu, press to scroll up. • While viewing image, press and hold to move the image upward.
17	▼ • While in a menu, press to scroll down. • While viewing image, press and hold to move the image downward.
18	► • While in a menu, press to select a feature. • While viewing image, press and hold to move the image rightward.
19	LCD display

Parent unit lights

LINK	On when the parent unit is linked to the baby unit. Flashes when the link to the baby unit being viewed in SINGLE-CAM or PATROL mode is lost; or when the link to all baby units being viewed in SPLIT-VIEW mode is lost.
	On when the parent unit is connected to AC power, or the battery is charging. Flashes when the parent unit battery is low and needs charging. Off when the parent unit is disconnected from AC power.
TALK	On when the parent unit is talking to the baby unit.
	On when the speaker volume of the parent unit is turned off.

Parent unit display icons

	Connection status • displays when strong signal strength is detected between the baby unit and the parent unit. • or displays when moderate or low signal strength is detected between the baby unit and the parent unit. • displays when the link between the baby unit and the parent unit is lost.
--	--

1 or 2 or 3 or 4	Current view status • Displays the number of the baby unit that is being viewed when in SINGLE-CAM mode. • Displays the highlighted baby unit when in SPLIT-VIEW mode.
	Patrol mode • Displays when the parent unit is in PATROL mode.
	Split-view mode • Displays when the parent unit is in SPLIT-VIEW mode.
	Night viewing • Displays when the camera has activated the night viewing feature.
	Zoom • Displays when the camera at the baby unit has zoomed in.
	Temperature alert • Displays when the temperature alert is set on.
57°F or 14°C	Real-time temperature • Displays the real-time temperature of the selected baby unit.
	Mute alert • Displays when the speaker volume is set to off. • Displays when SPLIT-VIEW mode is turned on.
	9-level sound indicator • (1 to 3 bars) indicates low sound level detected by the baby unit. • (4 to 6 bars) indicates moderate sound level detected by the baby unit. • (7 to 9 bars) indicates high sound level detected by the baby unit (e.g. baby crying loudly).
	Speaker volume • Displays the speaker volume level while adjusting.
	Battery status • animates when the battery is charging. • displays solid when the battery is fully charged. • displays when the battery is low and needs charging.

	AC power • Displays when the parent unit is connected to AC power without the battery.
	Language You can select a language (English, French or Spanish) to be used in all screen displays.
	Alert Tone You can set the parent unit to beep when • the parent unit operates in low battery condition; • the link between the parent unit and the baby unit is lost; or • the baby unit detects sounds while in SPLIT-VIEW mode.
	Sensitivity With this feature, you can choose to hear sounds from the baby unit all the time, or to hear sounds that exceed a certain level. You can use the parent unit to adjust the microphone sensitivity of your baby unit. The higher the sensitivity level, the more sensitive the baby unit is in detecting sounds for transmitting to the parent unit.
	Temperature You can turn on the temperature alert feature so that the parent unit beeps whenever the room temperature detected by the baby unit falls out of the desired temperature range.
	Vibration You can turn on the vibration alert so that the parent unit vibrates when it receives Low battery tone , No link alert , Sound alert in split-view or Temperature alert after these alert tones are turned on.
	Sound-activated Screen Automatically turns on the parent unit screen when a baby unit detects a sound after the screen is turned off. When no sound is detected, the screen is off to save power.

	LCD You can change the brightness of the parent unit screen, or turn on the Dim Mode to save power.
	Rename You can choose a specific name for the baby unit from a pre- defined name list.
	Pair/Unpair The baby unit and parent unit provided are already paired. You can add or replace baby units (VM314 , purchased separately) to your baby monitor system.

Parent unit display messages

	No link to CAM # (# represents the selected baby unit number).	The selected baby unit is out of range or is turned off.
	Battery low at Parent Unit	The battery level of the parent unit is very low and needs to be recharged.
Battery empty. Powering off ...		The battery is empty and needs to be recharged.
	Sound detected at CAM # (# represents the selected baby unit number).	The sound level exceeds the threshold at CAM # in SPLIT-VIEW mode.
	Temperature too low at CAM # (# represents the selected baby unit number).	The temperature detected from the selected baby unit is below the selected minimum temperature.
	Temperature too high at CAM # (# represents the selected baby unit number).	The temperature detected from the selected baby unit is above the selected maximum temperature.
	Powering on...	The parent unit is turning on.
		The parent unit is searching for baby units.

Using the baby monitor

Power on or off the baby unit

- Slide the **ON/OFF** switch to the left to turn
on the baby unit. The **ON/OFF** LED light
turns on.
- Slide the **ON/OFF** switch to the right to turn
off the baby unit. The **ON/OFF** LED light
turns off.

Power on or off the parent unit

- Press and hold **ON/OFF** to turn on the parent unit.
The screen turns on.
- Press and hold **ON/OFF** again to turn off the
parent unit. The screen turns off.

Turn on or off the parent unit
screen

You can turn on or off the parent unit screen
without powering off the parent unit.

- Press and hold **LCD ON/OFF** on the parent
unit to turn off the screen.
- Press any key on the parent unit to turn on
the screen again.

Adjust speaker volume

For baby unit:

- Press **+VOL** or **-VOL** on the parent unit at
any time when viewing images.

NOTE

- When the parent unit speaker volume is set to
zero, appears on the screen and the light
turns on.

For baby unit:

- Press **+VOL** or **-VOL** on the baby unit at
any time.

Set the language

You can select a language (English, French or
Spanish) to be used in all screen displays.

- Press **MENU** when the parent unit is idle.
- Press ▼ or ▲ to choose **Language**, then
press **SELECT**.
- Press ▼ or ▲ to choose **English, Français**
or **Español**, then press **SELECT** to confirm
your selection.

Adjust LCD brightness

You can change the brightness of the parent
unit screen from **Level 1** to **Level 5**. The LCD
brightness is preset to **Level 3**.

- Press **MENU** when the parent unit is idle.
- Press ▼ or ▲ to choose **LCD**, then press
SELECT.
- Press **SELECT** again to choose **Brightness**.
- Press ▼ or ▲ to choose the desired level of
brightness, then press **SELECT** to confirm
your selection.

Turn on or off the dim mode

The dim mode is preset to on to help you save
the parent unit power. Whenever the parent
unit has been left idle for 10 minutes while the
screen is still on, the screen will be dimmed
automatically to save power.

- Press **MENU** when the parent unit is idle.
- Press ▼ or ▲ to choose **LCD**, then press
SELECT.
- Press ▼ or ▲ to choose **Dim Mode**, then
press **SELECT**.
- Press ▼ or ▲ to choose **On** or **Off**, then
press **SELECT** to confirm your selection.

NOTE

- While the screen is dimmed, any keypress or
alert message will trigger the screen to return to
the preset brightness level. After 10 minutes of
idle, it will be dimmed again.

Adjust the sound sensitivity of
the baby unit

You can choose to hear sounds from the baby
unit all the time, or to hear sounds that exceed
a certain level. You can use the parent unit to
adjust the microphone sensitivity of your baby
unit from **Lowest** to **Highest**. The higher the
sensitivity level, the more sensitive the baby
unit is in detecting sounds for transmitting to
the parent unit. The sound sensitivity level is
preset to **Highest**.

Sound sensitivity table for reference

Sensitivity Level	Description
Highest	The parent unit speaker is constantly on, and you will hear all sounds (including background noises) from your baby’s room.
High	The parent unit speaker turns on for soft babbling and louder sounds from your baby. It remains quiet when your baby sleeps soundly.
Medium	The parent unit speaker turns on for loud babbling and louder sounds from your baby. It remains quiet when your baby makes soft sounds.
Low	The parent unit speaker turns on for crying and louder sounds from your baby. It remains quiet when your baby makes soft sounds.
Lowest	The parent unit speaker turns on for loud crying or screaming sounds from your baby. It remains quiet when your baby makes soft sounds.

- Press **MENU** when the parent unit is idle.
- Press ▼ or ▲ to choose **Sensitivity**, then
press **SELECT**.

- If you have more than one baby unit,
the system prompts you to choose
the desired baby unit or all baby units,
press ▼ or ▲ to choose **ALL CAM** or
CAM #, then press **SELECT**.

- Press ▼ or ▲ to choose the desired
sensitivity level, then press **SELECT** to
confirm your selection.

TIP

- You can adjust the baby unit placement to
improve the sound detection.

Monitoring mode

Every time the parent unit is turned on, it displays a baby unit in **SINGLE-CAM** mode. If there are more than one baby units in your system, you can also monitor your baby in **PATROL** or **SPLIT-VIEW** mode.

SINGLE-CAM - The screen displays a single baby unit in full screen.

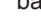
PATROL  - A single cam view that transits to a different baby unit every 10 seconds.

SPLIT-VIEW  - The screen displays all baby units (up to four) on one screen.

In **SINGLE-CAM** or **PATROL** mode:

- Press **VIEW** to view the next baby unit.
- Press **PATROL** to switch to **PATROL** mode if you are in **SINGLE-CAM** mode, and vice versa.
- Press **SPLIT** to enter the **SPLIT-VIEW** mode.

In **SPLIT-VIEW** mode:

- Press **▲**, **▼**, **◀** or **▶** to select a baby unit.
- Press **Q** or **VIEW** key to view the selected baby unit temporarily in **SINGLE-CAM** mode. It returns to **SPLIT-VIEW** mode after 10 seconds.
- Press **PATROL** to enter **PATROL** mode.
- Press **SPLIT** to return to the mode (**SINGLE-CAM** or **PATROL**), used before entering **SPLIT-VIEW** mode.

NOTE

- The parent unit is muted while in **SPLIT-VIEW** mode.

Zoom

You can zoom in or out while viewing image from baby unit in **SINGLE-CAM** and **PATROL** mode.

- Press **Q** to zoom in.
- Press and hold **▲**, **▼**, **◀** or **▶** to move the zoomed image upward, downward, leftward or rightward correspondingly.
- Press **Q** again to zoom out.

Talk

You can use the **TALK** function of the parent unit to comfort your baby in **SINGLE-CAM** and **PATROL** mode.

- Press and hold **TALK** on the parent unit. The **TALK** light turns on.
- Speak towards the microphone on the parent unit. Your voice is broadcast to the baby unit.
- Release the **TALK** key to stop the broadcast. The **TALK** light goes off.

Set alert tone

Low battery tone

You can set the parent unit to beep when the parent unit operates in low battery condition.

- Press **MENU** when the parent unit is idle.
- Press **▼** or **▲** to choose **Alert Tone**, then press **SELECT**.
- Press **SELECT** again to choose **Low Battery Tone**.
- Press **▼** or **▲** to choose **On** or **Off**, then press **SELECT** to confirm your selection.

No link alert

You can set the parent unit to beep when the link between the parent unit and the baby unit is lost.

- Press **MENU** when the parent unit is idle.
- Press **▼** or **▲** to choose **Alert Tone**, then press **SELECT**.
- Press **▼** or **▲** to choose **No Link Alert**, then press **SELECT**.
- Press **▼** or **▲** to choose **On** or **Off**, then press **SELECT** to confirm your selection.

Sound alert in split-view

You can turn on the sound alert feature so that, while in **SPLIT-VIEW** mode, the parent unit beeps and displays **Sound detected at CAM #** whenever the baby unit detects sounds.

- Press **MENU** when the parent unit is idle.
- Press **▼** or **▲** to choose **Alert Tone**, then press **SELECT** to select.
- Press **▼** or **▲** to choose **Sound alert in split-view**, then press **SELECT**.
- Press **▼** or **▲** to choose **On** or **Off**, then press **SELECT** to confirm your selection.

NOTE

- Make sure the screen is on in **SPLIT-VIEW** mode to use the sound alert feature.

Monitor the temperature

Your baby unit monitors the temperature of your baby's room with its built-in temperature sensor. If the detected temperature is out of the preset temperature range, the parent unit will display alert message.

Set temperature range

You can set the desired room temperature alert range. The minimum temperature can be set between **52 °F (11 °C)** and **69 °F (20 °C)**. The maximum temperature can be set between **70 °F (21 °C)** and **86 °F (30 °C)**.

- Press **MENU** when the parent unit is idle.
- Press **▼** or **▲** to choose **Temperature**, then press **SELECT**.
- Press **▼** or **▲** to choose **Minimum** or **Maximum**, then press **SELECT**.
 - If you have more than one baby unit, the system prompts you to choose the desired baby unit or all baby units, press **▼** or **▲** to choose **ALL CAM** or **CAM #**, then press **SELECT**.
- Press **▼** or **▲** to choose the desired minimum or maximum temperature, then press **SELECT** to confirm your selection.

Temperature alert tone

You can turn on the temperature alert tone so that the parent unit will emit an alert tone if the detected temperature is out of range.

- Press **MENU** when the parent unit is idle.
- Press **▼** or **▲** to choose **Temperature**, then press **SELECT**.
- Press **▼** or **▲** to choose **Alert Tone**, then press **SELECT**.
 - If you have more than one baby unit, the system prompts you to choose the desired baby unit or all baby units, press **▼** or **▲** to choose **ALL CAM** or **CAM #**, then press **SELECT**.
- Press **▼** or **▲** to choose **On** or **Off**, then press **SELECT** to confirm your selection.

Temperature format

You can choose to display the temperature in Fahrenheit (°F) or Celcius (°C).

- Press **MENU** when the parent unit is idle.
- Press **▼** or **▲** to choose **Temperature**, then press **SELECT**.
- Press **▼** or **▲** to choose **Format**, then press **SELECT**.
- Press **▼** or **▲** to choose **Fahrenheit** or **Celsius**, then press **SELECT** to confirm your selection.

Vibration

You can turn on the vibration feature so that the parent unit vibrates when it receives **Low battery tone**, **No link alert**, **Sound alert in split-view** or **Temperature alert** after turning on these alert tones.

- Press **MENU** when the parent unit is idle.
- Press **▼** or **▲** to choose **Vibration**, then press **SELECT**.
- Press **▼** or **▲** to choose **On** or **Off**.
- Press **SELECT** to confirm your selection.

Rename the baby unit

You can rename each baby unit. Once the baby unit is renamed, its new name together with the baby unit number will appear in the sub-menu of below options:

- Sensitivity
- Temperature
- Rename
- Pair/Unpair

- Press **MENU** when the parent unit is idle.
- Press **▼** or **▲** to choose **Rename**, then press **SELECT**.
- Press **▼** or **▲** to choose the desired baby unit, then press **SELECT**.
- Press **▼** or **▲** to choose the desired name for the baby unit, then press **SELECT** to confirm your selection.

Night vision

The baby unit has infrared LEDs that allow you to see your baby clearly at night or in a dark room. When the baby unit being viewed detects low light levels, the infrared LEDs are switched on automatically.

NOTES

- It is normal if you see a short white glare on your parent unit screen as the baby unit is adapting to the dark environment.
- When the infrared LEDs are on, the image is in black and white. This is normal due to external light sources.

TIP

- Depending on the surroundings and other interfering factors, like lightings, objects, colors and backgrounds, the display resolution may vary. Adjust the baby unit's angle or place the baby unit at a higher level to prevent glare and blurry display.

Add new baby unit (VM314)

The baby units and parent unit provided are already paired. You can add or replace any baby units (**VM314** purchased separately) to your video and audio monitor system. You can pair a maximum of four baby units to your parent unit.

For more details, refer to the user's manual that comes with your **VM314** new baby unit.

General product care

To keep this product working well and looking good, follow these guidelines:



- Avoid putting it near heating appliances and devices that generate electrical noise (for example, motors or fluorescent lamps).
- DO NOT expose it to direct sunlight or moisture.
- Avoid dropping the product or treating it roughly.
- Clean with a soft cloth.
- DO NOT immerse the parent unit and the baby unit in water and do not clean them under the tap.
- DO NOT use cleaning spray or liquid cleaners.
- Make sure the baby unit and parent unit are dry before you connect them to the mains again.

Storage

When you are not going to use the baby monitor for some time, remove the rechargeable battery from the parent unit. Store the parent unit, the baby unit and the adapters in a cool and dry place.

Frequently asked questions

Below are the questions most frequently asked about the baby monitor. If you cannot find the answer to your question, visit our website at **www.vtechphones.com**, or contact **1 (800) 595-9511** for customer service.

Why does the baby monitor not respond normally?	Try the following (in the order listed) for common sure: <ol style="list-style-type: none">Disconnect the power to the baby units and the parent unit. Remove the batteries in the parent unit. Then install the batteries again. Wait a few minutes before connecting power back to the baby units and the parent unit. Turn on the baby units and the parent unit. Wait for the parent unit to synchronize with the baby units. Allow up to one minute for this to take place.
Why don't the power-on light of the baby unit and parent unit go on when I switch on the units?	Perhaps the parent unit is not connected to the mains. Insert the appliance plug into the parent unit and put the adapter in a wall socket. Then press  to switch on the parent unit and to establish connection with the baby unit.
	Perhaps the baby unit is not connected to the mains. Connect the baby unit to the mains. Then set the  switch to ON to switch on the baby unit and to establish connection with the parent unit.
Why doesn't my parent unit charge while connected to AC power?	Make sure the power is not controlled by a wall switch. <p>You may have used the battery for a long time. Replace a new battery.</p>
Why is my screen in black and white?	The screen is in black and white during nighttime or in a dark room. This is normal due to external light sources.
Why do I get glare or blurry display on my screen when viewing my baby at night?	During nighttime or in a dark room, the surroundings and other interfering factors, like lightings, objects, colors and backgrounds may affect the image quality on your parent unit screen. Adjust the baby unit's angle or place the baby unit at a higher level to prevent glare and blurry display.
Why does the baby monitor produce a high-pitched noise?	The units may be too close to each other. Make sure the parent unit and the baby unit at least 1 meter/3 feet away from each other.

When you are not going to use the baby monitor for some time, remove the rechargeable battery from the parent unit. Store the parent unit, the baby unit and the adapters in a cool and dry place.

- Ne laissez aucun objet reposer ni appuyer sur le cordon d'alimentation. N'installez pas cet appareil dans un endroit où l'on risque d'écra ser le cordon d'alimentation ou de le piétner.
- Ne faites fonctionner cet appareil qu'avec le type d'alimentation indiqué sur l'étiquette. Si vous ne connaissez pas le type d'alimentation que vous possédez à votre domicile, consultez votre marchand ou votre compagnie locale d'électricité.
- Ne surchargez pas les prises de courant murales ni les rallonges électriques.
- Ne placez pas cet appareil sur un chariot, meuble, trépied, support de montage ni table chancelants.
- Les trous et ouvertures du boîtier, situés à l'arrière de l'appareil ou sous celui-ci, servent à aérer l'appareil. Pour l'empêcher de surchauffer, ne bloquez sous aucun prétexte ces ouvertures et n'empêchez pas l'aération adéquate de l'appareil en le plaçant sur un lit, divan, tapis ou de toute autre surface similaire. De même, ne le positionnez pas à proximité ni au-dessus d'une source de chaleur ou d'un calorifère. De plus, ne placez pas l'appareil dans un endroit avant de vous assurer qu'il y ait une bonne circulation d'air.
- N'enfoncez jamais d'objets à travers les ouvertures de cet appareil, car ils pourraient entrer en contact avec des points de tension dangereux ou causer des courts-circuits qui peuvent dégénérer en incendies ou en risques d'électrocution. Ne renversez jamais de liquide dans ce produit.
- Afin de réduire les risques d'électrocution, ne démontez pas cet appareil, mais apportez-le dans un centre de service autorisé. L'ouverture du boîtier ou le retrait de toutes pièces que contient cet appareil, à l'exception de l'accès autorisé à certaines portes ou ouvertures, risque de vous exposer à des points de tension dangereux ou d'autres dangers. Un remontage incorrect peut par la suite présenter des risques d'électrocution.
- Vous devriez tester la réception chaque fois que vous mettez l'appareil en fonction.
- Examinez les composantes afin de vérifier si celles-ci ne sont pas endommagées.
- Soyez avisé de la perte de la confidentialité lorsque vous utilisez les ondes publiques. Les conversations peuvent être entendues par d'autres moniteurs de bébé, des téléphones sans fil, des scanners, etc.
- Les enfants devraient être supervisés afin de vous assurer qu'ils ne jouent pas avec l'appareil.
- Le produit n'est pas conçu pour être utilisé par des personnes (incluant des enfants) aux capacités physiques, sensorielles ou mentales réduites ou qui manquent d'expérience et de connaissances, à moins qu'on leur ait donné suffisamment de supervision ou d'instructions relativement à l'utilisation de l'appareil par une personne responsable de leur sécurité.

Stimulateurs cardiaques implantés dans l'organisme

Les stimulateurs cardiaques (ne s'applique qu'aux dispositifs numériques sans fil) :

L'organisme "Wireless Technology Research, LLC (WTR)", une firme de recherche indépendante, a mené une évaluation pluridisciplinaire des interférences entre les téléphones sans fil portatifs et les stimulateurs cardiaques implantés dans l'organisme. Appuyée par l'Administration des aliments et drogues (FDA) des États-Unis, la firme WTR recommande aux médecins:

- Vous devriez maintenir les dispositifs sans fil à au moins six pouces du simulateur cardiaque.
- Ils ne doivent PAS placer le téléphone sans fil directement sur le stimulateur cardiaque, tel que dans une poche de chemise, lorsque celui-ci est en marche.

L'étude effectuée par l'organisme WRS n'a pas identifié de risque pour les détenteurs de stimulateurs cardiaques causés par les gens qui utilisent des dispositifs sans fil à proximité de ceux-ci.

Champs électromagnétiques (EMF)

Ce produit de VTech est conforme à toutes les normes se rapportant aux champs électromagnétiques (EMF) standard. Si vous le manipulez correctement en suivant les instructions de ce guide, son utilisation sera sécuritaire pendant de nombreuses années, selon les meilleures évidences scientifiques dont nous disposons aujourd'hui.

The ON/OFF light on the baby unit flashes and the parent unit displays T .	The baby unit is unpaired from the parent unit. Follow below steps to pair the baby unit. Make sure both parent unit and baby unit are on before pairing. <ol style="list-style-type: none">Press MENU when the parent unit is idle. Press ▼ or ▲ to choose Pair/Unpair CAM, then press SELECT. Press SELECT again to choose Pair CAM. Press ▼ or ▲ to choose an empty baby unit slot, then press SELECT. The parent unit screen displays Press and hold the pair button at the CAM for 5 seconds until the power indicator flashes.. Immediately press and hold PAIR on the bottom of the baby unit with a narrow pointed object such as a pencil. The LED light flashes quickly. <p>When pairing is successful, the screen displays the view of newly paired baby unit in SINGLE-CAM mode. The LED light on the new baby unit remains on.</p> <ul style="list-style-type: none">If pairing fails, the screen displays Pairing failed. Try the pairing process again. Only one baby unit can be paired at a time.
Why does the parent unit beep?	The baby units may be out of range. Move the parent unit closer to the baby units (but not less than 3 feet).
	If the parent unit is powered by the provided battery, it may not have enough charge for the parent unit to perform normally. Charge the battery in the parent unit for up to 3 hours.
	If your parent unit is in SPLIT-VIEW mode, some of your baby units may detect sounds.
Why does the parent unit beep/vibrate frequently in SPLIT-VIEW mode?	The temperature of your baby's room may be too high or too low.
Why does the parent unit react too quickly to other sounds?	You may have set the sound sensitivity level to level 5 when the sound alert (and vibration) feature are turned on. The parent unit notifies you of all sounds including background noise with beeps (or vibrations). Adjust the sound sensitivity to a lower level.
	The baby unit also picks up other sounds than those of your baby. Adjust the sensitivity level to a lower level or adjust the speaker volume on the parent unit.

Why don't I hear a sound/ Why can't I hear my baby cry?	The parent unit speaker volume may be too low or off. Press +VOL to increase the volume.
Why can't I establish a connection? Why is the connection lost every now and then? Why are there sound interruptions?	You may have set a low sound sensitivity level. See Adjust the sound sensitivity of the baby unit to change the setting.
	The baby units may be out of range. Move the parent unit closer to the baby units (but not less than 3 feet).
	Other electronic products may cause interference with your baby monitor. Try installing your baby monitor as far away from these electronic devices as possible.

Important safety instructions

When using your equipment, basic safety precautions should always be followed to reduce the risk of fire, electric shock and injury, including the following:

- Follow all warnings and instructions marked on the product.
- Adult setup is required.
- This product is intended as an aid. It is not a substitute for responsible and proper adult supervision and should not be used as such.
- This product is not intended for use as a medical monitor.
- Do not use this product near water. For example, do not use it next to a bath tub, wash bowl, kitchen sink, laundry tub or swimming pool, or in a wet basement or shower.
- CAUTION:** Use only the batteries indicated in this manual. There may be a risk of explosion if a wrong type of battery is used for the parent unit. Use only the supplied rechargeable battery or replacement battery pack (BT198555/ BT298555) for the parent unit. Do not dispose of batteries in a fire. They may explode. Dispose of used battery according to the information in The RBRC® seal.
- Use only the adapters included with this product. Incorrect adapter polarity or voltage can seriously damage the product. Baby unit power adapter: Input 100-240V AC 200mA 50/60 Hz; output: 5V DC 1000mA Parent unit power adapter: Input 100-240V AC 200mA 50/60 Hz; output: 5V DC 1000mA.
- The power adapters are intended to be correctly oriented in a vertical or floor mount position. The prongs are not designed to hold the plug in place if it is plugged into a ceiling, under-the-table or cabinet outlet.
- For plugable equipment, the socket-outlet shall be installed near the equipment and shall be easily accessible.

- Unplug this product from the wall outlet before cleaning. Do not use liquid or aerosol cleaners. Use a damp cloth for cleaning.
- Unplug the power cords before replacing batteries.
- Do not cut off the power adapters to replace them with other plugs, as this causes a hazardous situation.
- This product should be operated only from the type of power source indicated on the marking label. If you are not sure of the type of power supply in your home, consult your dealer or local power company.
- Do not overload wall outlets or use an extension cord.
- Do not place this product on an unstable table, shelf, stand or other unstable surfaces.
- This product should not be placed in any area where proper ventilation is not provided. Slots and openings in the back or bottom of this product are provided for ventilation. To protect them from overheating, these openings must not be blocked by placing the product on a soft surface such as a bed, sofa or rug. This product should never be placed near or over a radiator or heat register.
- Never push objects of any kind into this product through the slots because they may touch dangerous voltage points or create a short circuit. Never spill liquid of any kind on the product.
- To reduce the risk of electric shock, do not disassemble this product, but take it to an authorized service facility. Opening or removing parts of the product other than specified access doors may expose you to dangerous voltages or other risks. Incorrect reassembling can cause electric shock when the product is subsequently used.
- You should test the sound reception every time you turn on the units or move one of the components.
- Periodically examine all components for damage.
- Be aware of possible loss of privacy while using public airwaves. Conversations may be picked up by other nursery monitors, cordless phones, scanners, etc.
- Children should be supervised to ensure that they do not play with the product.
- The product is not intended for use by persons (including children) with reduced physical, sensory or mental capabilities, or lack of experience and knowledge, unless they have been given supervision or instruction concerning use of the appliance by a person responsible for their safety.

SAVE THESE INSTRUCTIONS

Cautions

- Use and store the product at a temperature between 32°F and 104°F.
- Do not expose the product to extreme cold, heat or direct sunlight. Do not put the product close to a heating source.
- Batteries should not be exposed to excessive heat such as bright sunshine or fire.
- Make sure the baby unit(s) and the adapter cord(s) are always out of reach of the baby, at least 3 feet away from the baby or crib, to avoid a possible strangulation hazard.
- Never place the baby unit(s) inside the baby's crib or playpen. Never cover the baby unit(s) or parent unit with anything such as a towel or a blanket.
- Other electronic products may cause interference with your baby monitor. Try installing your baby monitor as far away from these electronic devices as possible: wireless routers, radios, cellular telephones, intercoms, room monitors, televisions, personal computers, kitchen appliances and cordless telephones.

Precautions for users of implanted cardiac pacemakers

Cardiac pacemakers (applies only to digital cordless devices):

Wireless Technology Research, LLC (WTR), an independent research entity, led a multidisciplinary evaluation of the interference between portable wireless devices and implanted cardiac pacemakers. Supported by the U.S. Food and Drug Administration, WTR recommends to physicians that:

Pacemaker patients

- Should keep wireless devices at least six inches from the pacemaker.
- Should NOT place wireless devices directly over the pacemaker, such as in a breast pocket, when it is turned ON.

WTR's evaluation did not identify any risk to bystanders with pacemakers from other persons using wireless devices.

Electromagnetic fields (EMF)

This VTech product complies with all standards regarding electromagnetic fields (EMF). If handled properly and according to the instructions in this user's manual, the product is safe to be used based on scientific evidence available today.

The RBRC® seal

The RBRC® seal on the lithium-ion battery indicates that VTech Communications, Inc. is voluntarily participating in an industry program to collect and recycle these batteries at the end of their useful lives, when taken out of service within the United States and Canada.

The RBRC® program provides a convenient alternative to placing used lithium-ion batteries into the trash or municipal waste, which may be illegal in your area.

VTech's participation in RBRC® makes it easy for you to drop off the spent battery at local retailers participating in the RBRC® program or at authorized VTech product service centers. Please call **1 (800) 8 BATTERY®** for information on Li-ion battery recycling and disposal bans/restrictions in your area. VTech's involvement in this program is part of its commitment to protecting our environment and conserving natural resources.

 **RBRC® and 1 (800) 8 BATTERY® are registered trademarks of the Rechargeable Battery Recycling Corporation.**

FCC and IC regulations

FCC Part 15

This equipment has been tested and found to comply with the requirements for a Class B digital device under Part 15 of the Federal Communications Commission (FCC) rules. These requirements are intended to provide reasonable protection against harmful interference in a residential installation. This equipment generates, uses and can radiate radio frequency energy and, if not installed and used in accordance with the instructions, may cause harmful interference to radio communications. However, there is no guarantee that interference will not occur in a particular installation. If this equipment does cause harmful interference to radio or television reception, which can be determined by turning the equipment off and on, the user is encouraged to try to correct the interference by one or more of the following measures:

- Reorient or relocate the receiving antenna.
- Increase the separation between the equipment and receiver.
- Connect the equipment into an outlet on a circuit different from that to which the receiver is connected.
- Consult the dealer or an experienced radio/TV technician for help.

WARNING: Changes or modifications to this equipment not expressly approved by the party responsible for compliance could void the user's authority to operate the equipment.

This device complies with Part 15 of the FCC rules. Operation is subject to the following two conditions: (1) this device may not cause harmful interference, and (2) this device must accept any interference received, including interference that may cause undesired operation.

To ensure safety of users, the FCC has established criteria for the amount of radio frequency energy

that can be safely absorbed by a user or bystander according to the intended usage of the product. This product has been tested and found to comply with the FCC criteria. The baby unit shall be installed and used such that parts of all persons' body are maintained at a distance of approximately 8 in (20 cm) or more. The transmitter and antenna of the parent unit shall be held at least 1 in (2.5 cm) from your face.

This Class B digital apparatus complies with Canadian requirement: CAN ICES-3 (B)/NMB-3(B)

Industry Canada

This device complies with Industry Canada licence-exempt RSS standard(s).

Operation is subject to the following two conditions: (1) this device may not cause harmful interference, and (2) this device must accept any interference, including interference that may cause undesired operation.

The term "IC:" before the certification/registration number only signifies that the Industry Canada technical specifications were met.

This product meets the applicable Industry Canada technical specifications.

RF radiation exposure statement

The baby unit complies with FCC RF radiation exposure limits set forth for an uncontrolled environment. The baby unit should be installed and operated with a minimum distance of 8 in (20 cm) between the baby unit and all persons' body. Use of other accessories may not ensure compliance with FCC RF exposure guidelines. This transmitter must not be co-located or operating in conjunction with any other antenna or transmitter. This equipment complies also with Industry Canada RSS-102 with respect to Canada's Health Code 6 for Exposure of Humans to RF Fields.

California Energy Commission battery charging testing mode

This baby monitor meets the California Energy Commission (CEC) regulations for energy consumption. Your baby monitor is set up to comply with the energy-conserving standards right out of the box.

Follow the instructions to install and charge the battery. The CEC battery charging testing mode is activated while charging.

Even if the parent unit is paired to baby units, the CEC battery charging testing mode is activated while it is powered off and charging.

For cETL compliance only

Mesures de sécurité importantes

Lorsque vous utilisez votre appareil, vous devriez toujours suivre certaines mesures de précaution de base afin de réduire les risques d'incendie, d'électrocution et de blessures corporelles, dont ceux qui suivent :

- Observez toutes les instructions et mises en garde inscrites sur l'appareil.
- L'installation par un adulte est requise.
- Ce produit a été conçu pour être un dispositif d'appoint seulement. Il n'est pas le remplacement d'une supervision responsable et adéquate par ce produit et ne devrait pas être utilisé comme telle.
- Ce produit n'est pas conçu pour être utilisé en tant que moniteur médical.
- N'utilisez pas cet appareil près de l'eau ni de toute autre source d'humidité, par exemple, près d'une baignoire, cuve à lessive, évier de cuisine, dans un sous-sol humide ni près d'une piscine, dans un soussol humide ou une douche.
- MISE EN GARDE:** Il peut y avoir un risque d'explosion si vous utilisez le mauvais type de